



Huckle Close, Houghton Conquest, Bedford

Offers Over £650,000 Freehold

5 bedroom detached house for sale

Description

An opportunity to acquire a premium home within a newly established community within Houghton Conquest. Built by Tilia Homes to their 'Wentworth' design, this beautifully presented five-bedroomed home offers nearly 2600 square feet of accommodation and a double garage (part of which has been converted into a storeroom.)

This premium home offers its new owners the WOW factor, and our client's eye complements the generous accommodation for detail and excellent decorative taste.

Upon entering the home, you're immediately greeted by stylish and tasteful choices in a generously proportioned reception hall which paves the way to the accommodation on the ground floor and has the staircase rising to the first floor.

The house has two similarly generous reception rooms and a magnificent kitchen/dining/family room that has doors opening onto the rear garden. The Kitchen is a beautiful grey shaker style kitchen with integrated appliances with the base units complemented by white stonework surfaces over and breakfast bar. There is a separate utility with a sink and storage space with a door to the side of the house, and a shower room completes the floor.

The first floor comprises a generously appointed master suite that spans the whole side of the property above the double garage measuring more than 25 feet wide at its maximum point. A dressing room and an ensuite is complete this impressive suite. The rest of the floor comprises four double bedrooms (five in total), with a bathroom serving bedrooms 3,4 and 5 with bedroom two enjoying an ensuite shower room.

Outside the frontage, there is off road parking for numerous vehicles in front of the double garage, part of which has been converted into a separate storeroom.

The rear garden has a generously paved terrace close to the house, offering the perfect space to relax and entertain with the remainder laid on the lawn.

Tenure

Freehold



Huckle Close, Houghton Conquest, Bedford, MK45

Approximate Area = 2824 sq ft / 262.3 sq m

Limited Use Area(s) = 54 sq ft / 5 sq m

Total = 2878 sq ft / 267.4 sq m

For identification only - Not to scale

Denotes restricted head height

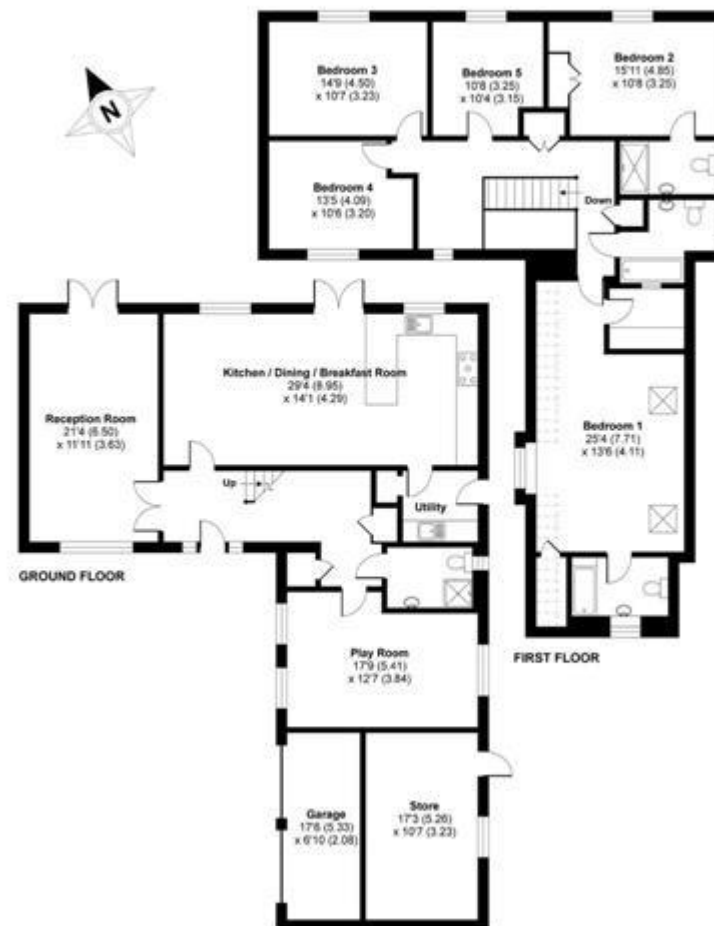

Floor plan produced in accordance with RICS Property Measurement Standards incorporating International Property Measurement Standards (IPMS) Residential. © rics.com 2021. Produced for James Kendall Estate Agents. REF: 743212



Viewing by appointment only
James Kendall Estate Agents - Head Office
194 Bedford Road, Kempston MK42 8BL
Tel: 01234 852434 Email: james@jameskendall.co.uk Website: www.jameskendall.co.uk

James Kendall
Estate Agents